



# CLERY REPORT 2015



MORENO  
VALLEY  
COLLEGE

## TABLE OF CONTENTS

President’s Message .....	3
Crime Statistics.....	4
Timely Warning Policy .....	5
Security and Access to Campus Facilities.....	7
Campus Law Enforcement .....	7
Programs Regarding Security Procedures and Practices .....	8
Programs Regarding Prevention of Crime .....	8
Monitoring of Criminal Activities Off-Campus .....	9
Policy Regarding Possession, Use and Sale of Alcoholic Beverages and Illicit Drugs .....	9
Sexual Assault Policy .....	10
Information Regarding Sex Offenders .....	12
Violence Against Women Act (VAWA).....	12
MVC Crisis Intervention Resource Team (CIRT).....	12
Emergency Response and Evacuation Procedures .....	12
Clery Act Definitions .....	14
Appendix A - Moreno Valley College Map .....	18



## President's Message

Dear Moreno Valley College Community:

Moreno Valley College (MVC) is committed to providing a safe and secure environment for our students, faculty, staff and visitors.

To that end, we are pleased to present the Annual Campus Security Policy and campus Crime Statistics Act Report for the 2015 calendar year.

This institutional report is prepared by MVC Police which is responsible for ensuring the safety and security of the MVC community from all hazards, including crime. This report will provide you with information on the safety and security on the MVC campus. Inside you will find information on the MVC Police Department, policies and procedures for reporting crime, safety and security prevention and protection programs, victim assistance services, and other material to assist you in maintaining your safety and security. This report is provided in compliance with the Jeanne Clery Disclosure of Campus Security Policy and Crime Statistics Act (Clery Act). We encourage you to read this information and consider how it can help you and the MVC community to prevent and protect yourself against crime. Thank you for taking time to review this information and helping to make MVC a safer community.

The full text of this report is available online at [www.mvc.edu](http://www.mvc.edu). This report is prepared in cooperation with the Riverside Community College District Police Department, District Human Resources, Vice President of Student Services, Vice President of Administrative Services, and the District Public information Office. These entities provide updated information on their educational efforts and programs to comply with the Act.

If you are concerned about distressed, disruptive or dangerous behavior in a fellow student, the Moreno Valley Crisis College Intervention Resources Team (CIRT) members will be able to help. The CIRT website at [www.mvc.edu/services/hs/cit.cfm](http://www.mvc.edu/services/hs/cit.cfm) has contact information for CIRT members as well as a list of resources.

If you have any questions or suggestions concerning this publication, please contact the Riverside Community District Police department at (951) 222-8171.

Best Regards,

A handwritten signature in black ink that reads "Sandy Mayo". The signature is written in a cursive, flowing style.

Sandy Mayo, Ed.D.

President

## CRIME STATISTICS

The following crime statistics for Moreno Valley College have been compiled by the Riverside Community College District (RCCD) Police Department, in conjunction with local law enforcement agencies surrounding the campus. Campus crime, arrest and referral statistics include those reported to the Riverside Community College District Police Department, campus security authorities, and local law enforcement agencies.

RCCD has certain mandatory crime reporting obligations under state law. The Child Abuse Neglect and Reporting Act (“CANRA,” Penal Code section 11164 et seq.) requires employees to report known or suspected instances of child abuse or neglect to law enforcement by health care practitioners (such as employees or contractors in the Student Health Center) when they provide medical services to a person they know or reasonably suspect is suffering from wounds inflicted by a firearm or are result of assaultive or abusive conduct.

Campus/Location	Homicide, Negligent						Homicide, Non Negligent						Sex Offense, Forcible						Sex Offense, Non Forcible								
	Public Prop			On Campus			Public Prop			On Campus			Public Prop			On Campus			Public Prop			On Campus					
	Year	12	13	14	12	13	14	12	13	14	12	13	14	12	13	14	12	13	14	12	13	14	12	13	14		
Moreno Valley	0	0	0	0	0	0	0	0	0	0	0	0	0	0	0	0	0	0	0	0	0	0	0	0	0	0	0
Ben Clark Training Center	0	0	0	0	0	0	0	0	0	0	0	0	0	0	0	0	0	0	0	0	0	0	0	0	0	0	0

Campus/Location	Hate Crimes						Motor Vehicle Theft						Arson						Burglary								
	Public Prop			On Campus			Public Prop			On Campus			Public Prop			On Campus			Public Prop			On Campus					
	Year	12	13	14	12	13	14	12	13	14	12	13	14	12	13	14	12	13	14	12	13	14	12	13	14		
Moreno Valley	0	0	0	0	0	1	0	0	0	1	1	1	0	0	0	0	0	1	0	0	0	1	0	0	1	0	3
Ben Clark Training Center	0	0	0	0	0	0	0	0	0	0	0	0	0	0	0	0	0	0	0	0	0	0	0	0	0	0	0

Campus/Location	Robbery, Armed						Robbery, Strong-Arm						Aggravated Assault								
	Public Prop			On Campus			Public Prop			On Campus			Public Prop			On Campus					
	Year	12	13	14	12	13	14	12	13	14	12	13	14	12	13	14	12	13	14		
Moreno Valley	0	0	0	0	0	0	0	0	0	0	0	0	0	0	0	0	0	0	0	1	1
Ben Clark Training Center	0	0	0	0	0	0	0	0	0	0	0	0	0	0	0	0	0	0	0	0	0

Campus/Location	Liquor Law Violations						Drug Law Violations						Illegal Weapons Possession					
	Public Prop			On Campus			Public Prop			On Campus			Public Prop			On Campus		
	Year	12	13	14	12	13	14	12	13	14	12	13	14	12	13	14	12	13
Moreno Valley	0	0	0	0	0	0	0	0	0	0	0	1	0	0	0	0	0	0
Ben Clark Training Center	0	0	0	0	0	0	0	0	1	0	0	0	0	0	0	1	0	0

Campus/Location	VAWA ~ Domestic Violence						VAWA ~ Dating Violence						VAWA ~ Stalking					
	Public Prop			On Campus			Public Prop			On Campus			Public Prop			On Campus		
Year	12	13	14	12	13	14	12	13	14	12	13	14	12	13	14	12	13	14
Moreno Valley	-	-	0	-	-	0	-	-	0	-	-	0	-	-	0	-	-	0
Ben Clark Training Center	-	-	0	-	-	0	-	-	0	-	-	0	-	-	0	-	-	0

### TIMELY WARNING POLICY

When a crime is reported to the District Police on campus and/or the campus administration that, in the judgment of the College President, the Vice President, Business Services or the Duty Administrator creates a serious or ongoing threat, a campus-wide “timely warning” will be issued.

The warning will be issued through the following college notification systems to students, faculty and staff:

- **College Emergency Notification System** - Text messages, emails and phone calls will be made by RCCD’s Emergency Notification System. More information can be found in Board Policy 3505 on the RCCD website at: [www.rccd.edu/administration/board/Pages/BoardPolicies.aspx](http://www.rccd.edu/administration/board/Pages/BoardPolicies.aspx)
- **Website News post or Message** - The college intranet will post messages on all computer screens throughout the campus warning of any imminent danger.
- **Signage** - Placed in areas of high traffic and closed entrances or buildings.
- **Other areas** - To be coordinated with the District Police and other campus departments.

Anyone with information warranting a timely warning should contact the District Police Department by phone at (951) 222-8171 or in person at the Police Office located in Lovekin 1-3.

### GUN-FREE CAMPUS

Board Policy 3530 on the RCCD website at:

[www.rccd.edu/administration/board/Pages/BoardPolicies.aspx](http://www.rccd.edu/administration/board/Pages/BoardPolicies.aspx)

## HOW TO REPORT A CRIME

To report a crime, please contact the District Police Department at (951) 222-8171 blue emergency telephones located in certain areas of the campus (See Appendix A-campus map). To use the emergency phones simple press the button on the front of the phone box to be connected to the Police Department Dispatch.

You may also report crime to the campus officials on the following page that is designated as Campus Security Authorities:

<b>Campus Security Authorities</b>			
<b>POSITION</b>	<b>NAME</b>	<b>PHONE</b>	<b>LOCATION</b>
<b>President</b>	Sandra Mayo	(951) 571-6160	Student Academic Services
<b>Vice President, Academic Affairs</b>	Robin Steinback	(951) 571-6350	Student Academic Services
<b>Vice President, Business Services</b>	Norm Godin	(951) 571-6341	Student Academic Services
<b>Vice President, Student Services</b>	Dyrell Foster	(951) 571-6120	Student Services Building
<b>Dean, Student Services</b>	Eugenia Vincent	(951) 571-6384	Student Services Building
<b>Dean, Student Services (Counseling)</b>	MichaelPaul Wong	(951) 571-6251	Humanities Building
<b>Dean of Instruction</b>	David Vakil	(951) 571-6384	Student Academic Services
<b>Dean of Instruction (Career/Tech Ed)</b>	Melody Graveen	(951) 571-6291	Parkside Complex 15
<b>Dean of Instruction (Public Safety)</b>	Art Turnier	(951) 571-6320	Ben Clark Training Center
<b>Director, Health Services</b>	Sue Tarcon	(951) 571-6103	Parkside Complex 6

Employees who are listed above as “Campus Security Authorities” understand that it’s their obligation to forward reports of crime promptly to the District Police Department. RCCD does not have procedures allowing victims or witnesses to report crimes on a voluntary, confidential basis for inclusion in the annual disclosure of crime statistics.

Police reports are considered public records under state law, and reports of crime cannot be held in complete confidence. However, victims of sexual violence may request to law enforcement that their names not become a matter of public record (Penal Code section 293).

## SECURITY AND ACCESS TO CAMPUS FACILITIES

No visitor on campus shall attend a college activity limited to college personnel without prior approval of the college president or his/her authorized representative. Any visitor on campus may attend a college event which is authorized as open to the public per Board Policy 3501 on the RCCD website at: [www.rccd.edu/administration/board/Pages/BoardPolicies.aspx](http://www.rccd.edu/administration/board/Pages/BoardPolicies.aspx)

College premises shall not be used later than 11:00 p.m. except upon special permission from the college president or designee.

RCCD employs the Riverside Community College District Police Department on a full time basis, to provide law enforcement support and emergency response to the colleges. The college maintains its premises and security by continuous patrol by the District Police Department. All facilities are secured through locking mechanisms which are either hard key or card key enabled. The campus has established a policy which identifies those individuals who are authorized to be issued hard keys and also established the access allowed by key card entry. Access identification is authorized on a "needed access" basis as submitted by a Department Chair, Dean or Vice President and approved by the Vice President, Business Services or the college President. All facilities are secured during non-business hours and access after business hours is authorized on an approved basis or through the District Police Department. RCCD security is also assisted by a video camera system which records activity in the vicinity of the cameras. The camera system is managed by the District Risk Management Office.

## CAMPUS LAW ENFORCEMENT

### **Authority of the Riverside Community College District Police Department**

RCCD Police provide law enforcement services to all RCCD properties and colleges. RCCD Police has authority to apprehend and arrest individuals involved in illegal activity on all District owned properties and areas within the immediate vicinities of District owned properties. District Police Officers are peace officers as defined in Penal Code section 830.32 and have peace officer powers throughout the State of California.

Crimes occurring on campus are investigated by the District Police Department. Prosecution of criminal offenses, both felonies and misdemeanors; occur at the Riverside Superior Court (for violations of state law) or the United States District Court, Southern District of California (for violations of federal law). District Police Department personnel work as appropriate with local, state and federal law enforcement agencies, and have access to national crime databases.

The District Police Department maintains a daily crime log of criminal incidents and alleged criminal incidents which are reported to the District Police Department. This log can be viewed by the public during normal business hours and can be found at the police office located in Lovekin Portables 1-3.

### **Accurate and Prompt Reporting of Crimes to Law Enforcement**

To ensure the safety of everyone on campus, RCCD Police encourages the accurate and prompt reporting of crimes to the District Police Department at (951) 222-8171 Police Office located in Lovekin 1-3.

### **Professional Counselors**

A professional counselor whose official responsibilities include mental health counseling to members of the community and who is functioning within the scope of his/her license or certification is exempt from disclosing reported offenses to law enforcement, unless there is a legal obligation to disclose. Personal information from counseling records will not be revealed unless disclosure is required by law. However, counselors may encourage victims to make reports to law enforcement.

## **PROGRAMS REGARDING SECURITY PROCEDURES AND PRACTICES**

RCCD maintains a 24/7 security and safety presence on the campus. The District Police Department proactively patrols the campus and engages individual's involved in suspicious or criminal activity. The District Police Department assists students and visitors with safety information and directions to locations and events. Besides patrol and prevention, the District Police department also educates the campus on personal crime prevention and safety.

In addition to the District Police Department the campus relies on allied agencies for additional response and support as needed. Emergency services for fire and first aid response are generally provided by the local Fire Departments.

### **PROGRAMS REGARDING PREVENTION OF CRIME**

The District Police Department provides safety and security information as well as information about crimes, crime reporting and general personal safety. Brochures are available in the RCCD police office (Lovekin 1-3) relating to sexual assault, community policing, terrorist attacks, protecting privacy, child abuse, and hazardous materials.

The District Police Department has a list of safety tips for students and parents that will help prevent problems on campus. Those safety tips are:

- MVC has Blue Emergency phones located in certain areas around campus. Know where these are. (See Appendix A-campus map)
- Have a safety buddy, someone you can call for a ride or help, and create a code word or phrase that means "Come help me out of this" or "I'm in trouble."
- If you are on campus at night and feel uncomfortable walking to your car or the bus station please call the District Police Department at (951) 222-8171 and ask for the escort services to accompany you to your campus destination.
- If you are walking to your vehicle alone (day or night) make sure you have your keys ready when you get to the car. Do not delay in getting into the car and locking the doors for safety
- Always be aware of our surroundings and any suspicious activity in your area. If you are concerned call the District Police Departments at (951) 222-8171 or use a blue Emergency phone.
- Before going to a party, tell a friend where you're going and when you'll be back. Let them know if your plans change.
- Take turns being a designated driver or sober companion. You could save someone's life.
- If a party gets out of hand, leave!
- Never, ever leave your drink alone or with someone you don't know. Date rape drugs are easy to use and men are just as vulnerable as women.
- Don't take drinks or anything else from strangers, even food.
- Don't ride with drunk or drugged drivers.
- Don't offer rides to people you don't know.
- Trust your instinct!

And here's what parents can do:

- Ask the college administrators about campus alcohol policies.
- Talk to your kids about the legal penalties for underage drinking.
- Discuss the possible consequences of drinking, including date rape, violence, and school interference.



- Know your child's roommate and living arrangements.
- Call your son or daughter frequently

The District Police Department provides an escort service available during operating hours (24/7) to accompany students to their cars or bus stops on the campus periphery. Anyone may report a crime or other suspicious activity anonymously to the District Police Department.

### **MONITORING OF CRIMINAL ACTIVITIES OFF-CAMPUS**

RCCD does not have recognized off-campus locations of student organizations, such as off-campus housing facilities, and does not engage in monitoring of student criminal activity off-campus. However, students engaging in criminal activities off-campus, in conjunction with college-sponsored activities, may be subject to disciplinary action by RCCD.

### **POLICY REGARDING POSSESSION, USE, AND SALE OF ALCOHOLIC BEVERAGES AND ILLICIT DRUGS**

RCCD is committed to drug-free and alcohol-free campuses. Students and employees are prohibited from unlawfully possessing, using or distributing illicit drugs and alcohol on District premises, in District vehicles, or as part of any activity of the District or colleges of the District.

RCCD Board Policy prohibits the following:

#### **Penalties**

Federal and state laws regarding alcohol and illicit drugs allow for fines and/ or imprisonment. Other legal problems include the loss of one's driver's license and limitations of career choices. A summary of federal penalties for drug related offenses is available at: [www.dea.gov/druginfo/ftp3.shtml](http://www.dea.gov/druginfo/ftp3.shtml)

The federal Controlled Substances Act is available at:

[www.dea.gov/diversion.usdoj.gov/21cfr/21usc/index.html](http://www.dea.gov/diversion/usdoj.gov/21cfr/21usc/index.html)

In addition to criminal prosecution, violators are also subject to disciplinary action by RCCD. Student discipline actions may include the following: warning, reprimand, disciplinary probation, suspension, and/or expulsion.

#### **Health Risks**

Health risks associated with the abuse of controlled substances include malnutrition, damage to various organs, hangovers, blackouts, general fatigue, impaired learning, dependency, disability and death. Both drugs and alcohol may be damaging to the development of an unborn fetus. Personal problems include diminished self-esteem, depression, alienation from reality, and suicide. Social problems include alienation from and abuse of family members, chronic conflict with authority, and loss of friends, academic standing, and/or co- and extra-curricular opportunities. A description of various drugs and their effects is available at: [www.justice.gov/dea/druginfo/factsheets.shtml](http://www.justice.gov/dea/druginfo/factsheets.shtml)

#### **Drug and Alcohol Prevention Programs**

RCCD uses referral services for Drug and Alcohol prevention and treatment programs. Please refer to the RCCD Student Health webpage on the RCCD website at:

[www.rccd.edu/services/health/Pages/Addiction.aspx](http://www.rccd.edu/services/health/Pages/Addiction.aspx)

## **Resources for Counseling, Treatment and Rehabilitation**

The following counseling, treatment, and rehabilitation resources are available for the treatment of alcohol and drug dependence and abuse.

National Council on Alcoholism and Drug Dependence

[www.ncadd.org](http://www.ncadd.org)

(800) NCA-CALL

California Department of Alcohol and Drug Programs

[www.dhcs.ca.gov](http://www.dhcs.ca.gov)

(800) 879-272

Alcoholics Anonymous

[www.aa.org](http://www.aa.org)

(800) 923-8722

Cocaine Anonymous

[www.ca.org](http://www.ca.org)

310-559-5833

Narcotics Anonymous

[www.na.org](http://www.na.org)

(800) 863-2962

Families Anonymous

[www.familiesanonymous.org](http://www.familiesanonymous.org)

(800) 736-9805

## **SEXUAL ASSAULT POLICY**

The District's complete sexual assault policy, 3540 is available on the RCCD website at:

[www.rccd.edu/administration/board/Pages/BoardPolicies.aspx](http://www.rccd.edu/administration/board/Pages/BoardPolicies.aspx)

### **Educational Programs**

RCCD provides the following educational programs through its CARE program to promote the awareness of rape, acquaintance rape, and other forcible and non-forcible sex offenses.

A common theme of all awareness and crime prevention programs is to encourage students and employees to be aware of their responsibility for their own security and the security of others.

In addition to seminars, information is disseminated to students and employees through crime prevention awareness packets, security alert posters, displays, videos, and articles and advertisements in college and student publications.

When time is of the essence, information is released to the college community through security alerts on Blackboard as well as through loudspeakers and other communication methods.

## Who to Contact

If you are the victim of sexual assault on campus, you should immediately contact the District Police Department.

RCCD strongly encourages timely reporting of sexual assaults, so that evidence may be collected and preserved. Campus law enforcement and the Campus Violence Response Team can ensure that immediate medical attention is provided, assure the victim that confidentiality will be maintained (unless the victim otherwise consents), inform the victim of legal and disciplinary options, and provide the victim with appropriate referrals.

Within 24 hours of being notified of a sexual assault, campus law enforcement shall, with the consent of the alleged victim, notify the College President of the sexual assault and victim's name per board policy.

### **On-Campus Resources for Victim of Sexual Assault**

District Police Department	(951) 222-8171
Crisis Intervention Resource Team	(951) 571-6103
Student Health Center	(951) 571-6103
Dean of Student Services	(951) 571-6384

### **Off-Campus Resources for Victim of Sexual Assault**

Riverside Area Rape Crisis Center	(951) 686-7273	www.rarcc.org
The Center Against Sexual Assault	(866) 373-8300	www.smedelstein.com
Rape and Battering Hotlines	(800) 339-7233	www.alternativestody.org
Violence Hotline	(800) 799-SAFE	N/A
National Sexual Assault Hotline	(800) 656-HOPE	N/A

## Changes to Academic Situation

MVC will comply with a victim's request for an academic situation change following an alleged sex offense, if such changes are reasonably available. For example, MVC may, consistent with Board policy, provide the option of taking "withdrawal" or "incomplete" grades.

## Student Discipline for Sex Offenses

If the alleged perpetrator is a student, he/she may also be disciplined by the college for violating the District's Code of Conduct. Procedures for campus disciplinary actions are available in RCCD Board Policy 3540.

[www.rccd.edu/administration/board/Pages/BoardPolicies.aspx](http://www.rccd.edu/administration/board/Pages/BoardPolicies.aspx)

The accused and accuser may have others present during a campus disciplinary hearing, with the exception of representation counsel per RCCD Board Policy 5520 at:

[www.rccd.edu/administration/board/Pages/BoardPolicies.aspx](http://www.rccd.edu/administration/board/Pages/BoardPolicies.aspx)

Both alleged perpetrator and alleged victim shall be informed of the status and result of any student disciplinary proceedings (RCCD).

Possible sanctions following a disciplinary hearing include, but not are limited to, suspension or expulsion from all of the District's colleges. These are separate penalties that what may be imposed by a criminal or civil court.

## **INFORMATION REGARDING SEX OFFENDERS**

Registered sex offenders must register with campus law enforcement within five working days of commencing enrollment or employment at RCCD (Penal code section 290).

Information regarding registered sex offenders may be obtained at the California Department of Justice, Office of Attorney General's "Megan's Law" website, at: [www.meganslaw.ca.gov/](http://www.meganslaw.ca.gov/)

## **VIOLENCE AGAINST WOMEN ACT (VAWA)**

Moreno Valley College (MVC) is committed to providing a safe learning and working environment. In compliance with federal laws, policies and procedures have been adopted to raise awareness, prevent, and respond to incidents of sexual assault, domestic violence, dating violence, and stalking involving members of the campus community. These guidelines apply to all students, faculty, staff, contractors and visitors.

### **Reporting an Incident**

If a student, employee or visitor has been the victim of a sexual assault, domestic violence, dating violence, or stalking, they should immediately call the Riverside District Police Department at 951-222-8171. In the case of an emergency or ongoing threat please get to a safe location and call 911 or the local law enforcement agency.

Students, employees or visitors may also report incidents to:

Georgina Villasenor, RCCD Human Resources Analyst, (951) 328-3725.

These offices will assist any victim of sexual assault, domestic violence, dating violence, and stalking in notifying law enforcement, including local police.

## **MVC CRISIS INTERVENTION RESOURCE TEAM (CIRT)**

The Moreno Valley College Crisis Intervention Resource Team (CIRT) provides support to facilitate, coordinate and provide for psychological evaluation and behavioral intervention when needed. The team monitors, "connects event dots," and is available as a behavioral intervention resource to prevent a crisis and promote emotional and behavioral wellness in a student of concern, so that student can function optimally in the classroom. Pro-active Crisis Intervention Team involvement helps prevent student crisis on a personal level, so that with early intervention, a distressed student can stay in school and accomplish his or her goals. Furthermore, by helping individual students, Moreno Valley College campus safety is enhanced for everyone. For more information visit: [www.mvc.edu/services/hs/cit.cfm#contactus](http://www.mvc.edu/services/hs/cit.cfm#contactus)

## **EMERGENCY RESPONSE AND EVACUATION PROCEDURES**

RCCD will immediately notify the campus community upon confirmation of a significant emergency or dangerous situation involving an immediate threat to the health and safety of students and employees occurring on the campus. Such notification will be made during such emergencies as outbreaks, extreme weather conditions, earthquakes, gas leaks, terrorist incidents, armed intruders, bomb threats, civil unrest, explosions, chemical or hazardous waste spills, etc.

To report an emergency, please contact the District Police Department at (951) 222-8171 or use one of the blue emergency phones on the Campus.

## **Notification Procedures**

In the event of a campus emergency, where it is necessary to notify students and staff of impending danger or critical information Riverside Community College District has developed a protocol to engage as many students and staff as possible, in the shortest amount of time. All current technology and communication modes will be used to distribute information as quickly as possible. Coordination with the President's Office, the campus Police Department office, district personnel and Public Relations needs to be immediate and ongoing.

Communications checklist for critical information is listed on the Timely Warning Policy on Page 2.

RCCD will, without delay, and taking into account the safety of the community, determine the content of the notification will, in the professional judgement of the responsible authorities, compromise efforts to assist a victim or to contain, respond, otherwise mitigate the emergency.

The entire campus community will be notified when there is a potential that a very large segment of RCCD is threatened. The President's Office, the RCCD Police Department's Office, District Personnel, and Public Relations will reassess the situation to determine whether additional notifications or updates need to be made.

## **Emergency Response General Procedures**

The emergency response policies and procedures for the following incidents are on the RCCD website per Board Policy 3505: [www.rccd.edu/administration/board/Pages/BoardPolicies.aspx](http://www.rccd.edu/administration/board/Pages/BoardPolicies.aspx), and a hard copy is maintained in most administrative offices:

- A. Fire
- B. Earthquake
- C. Serious Accident/ Injury
- D. Crime in Progress/ Civil Disturbance
- E. Evacuation of Persons with Disabilities
- F. Chemicals Spills/ Fires
- G. Flooding/ Water Damage
- H. Bomb threat
- I. Utility Failure/ Power Outage
- J. Verbal or Written Threats
- K. Severe Wind

## **Testing of Procedures**

RCCD conducts both announced and unannounced tests of its emergency response and evacuation procedures. District Risk Management and the RCCD Police Department will monitor all announced tests of its emergency response and evacuation procedures.

RCCD publicizes its emergency response and evacuation procedures by

1. The posting of emergency response and evacuation procedures on the RCCD website
2. Providing emergency information in our School Catalog
3. Providing other emergency notifications and procedures through the college's emergency notification system

RCCD will document each test by recording a description of the test, the date the test was held, the time the test started and ended, and whether the test was announced or unannounced. Copies of test documentation are available from the District Risk Management Office.

## CLERY ACT DEFINITIONS

### Campus Geography

**On-Campus:** Any building or property owned or controlled by an institution within the same reasonably contiguous geographic area and used by the institution in direct support of or in a manner related to the institution's educational purposes, including any building or property that is owned by the institution but controlled by another person, is frequently used by students, and supports institutional purposes.

**Non-Campus Building or Property:** Any building or property owned or controlled by a student organization that is officially recognized by the institution; or any building or property owned or controlled by an institution that is used in direct support of or in relation to the institution's educational purposes, is frequently used by students, and is not within the same reasonably contiguous geographic area of the institution.

**Public Property:** All public property, including thoroughfares, streets, sidewalks, and parking facilities, that is within the campus or immediately adjacent to and accessible from the campus.

### Crime Definitions for Reportable Crimes

**Murder/Non-Negligent Manslaughter:** The willful (non-negligent) killing of one human being by another.

**Manslaughter by Negligence:** The killing of another person through gross negligence.

**Sex Offenses-Forcible:** Any sexual act directed against another person, forcibly and/or against that person's will; or not forcibly or against the person's will where the victim is incapable of giving consent.

- a. **Forcible Rape** – carnal knowledge of a person, forcibly and/or against the person's will; or not forcibly or against the person's will where the victim is incapable of giving consent because of his/her temporary or permanent mental or physical incapacity (or because of his/her youth).
- b. **Forcible Sodomy** – oral or anal sexual intercourse with another person, forcibly and/or against that person's will; or not forcibly and/or against the person's will where the victim is incapable of giving consent because of his/her youth or because of his/her temporary or permanent mental or physical incapacity.
- c. **Sexual Assault With An Object** – use of an object or instrument to unlawfully penetrate, however slightly, the genital or anal opening of the body of another person, forcibly and/or against that person's will; or not forcibly and/or against the person's will where the victim is incapable of giving consent because of his/her youth or because of his/her temporary or permanent mental or physical incapacity.
- d. **Forcible Fondling** – touching of the private parts of another person for the purpose of sexual gratification, forcibly and/or against that person's will or, not forcibly and/or against the person's will where the victim is incapable of giving consent because of his/her youth or because of his/her temporary or permanent mental or physical incapacity.

**Sex offenses-Non Forcible:** Unlawful, non-forcible sexual intercourse (limited to incest and statutory rape).

- a. **Incest** –non-forcible sexual intercourse between persons who are related to each other within the degrees wherein marriage is prohibited by law.
- b. **Statutory Rape** – non-forcible sexual intercourse with a person who is under the age of consent.

**Robbery:** Taking or attempting to take anything of value from the care, custody or control of a person or persons by force or threat of force or violence and/or by putting the victim in fear.

**Aggravated Assault:** Unlawful attack by one person upon another for the purpose of inflicting severe or aggravated bodily injury. Usually accompanied by the use of a weapon or by means likely to produce death or great bodily harm.

**Burglary:** Unlawful entry of a structure to commit a felony or a theft.

**Motor Vehicle Theft:** The theft or attempted theft of a motor vehicle. There are three classes of motor vehicles: (1) autos, (2) trucks and buses, (3) and other vehicles.

**Larceny Theft:** The unlawful taking, carrying, leading, or riding away of property from the possession or constructive possession of another.

**Arson:** Any willful or malicious burning or attempt to burn with or without intent to defraud, a dwelling house, public building, motor vehicle or aircraft, or personal property of another, etc.

**Vandalism:** To willfully or maliciously destroy, injure, or deface any public or private property, real or personal, without the consent of the owner or person having custody or control by cutting, tearing, breaking, marking, painting, drawing, covering with filth, or any other such means as may be specified by local law.

**Liquor Law Violations:** The violation of state or local laws or ordinances prohibiting the manufacture, sale, purchase, transportation, possession, or use of alcoholic beverages, not including driving under the influence and drunkenness.

**Drug Abuse Violations:** The violation of laws prohibiting the production, distribution, and/or use of certain controlled substances and the equipment or devices utilized in the preparation and/or use. The unlawful cultivation, manufacture, distribution, sale, purchase, use, possession, transportation, or the importation of any controlled drug or narcotic substance. Arrests for violations of state and local laws, specifically those relating to the unlawful possession, sale, use, growing, manufacturing, and making of narcotic drugs.

**Weapon Law Violations:** The violation of laws or ordinances prohibiting the manufacture, sale, purchase, transportation, possession, concealment, or use of firearms, cutting instruments, explosives, incendiary devices, or deadly weapons.

### **Violence Against Women Act (VAWA) Definitions**

#### **Domestic Violence**

(1) A felony or misdemeanor crime of violence committed-

- a. By a current or former spouse or intimate partner or the victim;
- b. By a person with whom the victim shares a child or common;
- c. By a person who is cohabitating with or has cohabitated with the victim a spouse or intimate partner;
- d. By a person similarly situated to a spouse of a victim under the domestic or family violence laws of the jurisdiction in which the crime of violence occurred, or
- e. By any other person against an adult or youth victim who is protected from that person's acts under the domestic or family violence laws of the jurisdiction in which the crime of violence occurred.

(2) For the purpose of complying with the requirements of this section and section 668.41, any incident meeting this definition is considered a crime for the purposes of Clery Act reporting.

## **Dating Violence**

- (1) Violence committed by a person who is or has been in a social relationship of a romantic or intimate nature with the victim.
- (2) The existence of such a relationship shall be determined based on the reporting party's statement and with consideration of the length of the relationship, the type of relationship, and the frequency of interaction between the persons involved in the relationship.
- (3) For the purposes of this definition-
  - a. Dating violence includes, but is not limited to, sexual or physical abuse or threat of such abuse.
  - b. Dating violence does not include acts covered under the definition of domestic violence.
  - c. For the purpose of complying with the requirements of this section and section 668.41, any incident meeting this definition is considered a crime for the purposes of Clery Act reporting.

## **Stalking**

- (1) Means a course of conduct directed at a specific person that would cause a reasonable person to fear for her, his, or others' safety, or to suffer substantial emotional distress.
- (2) For the purpose of complying with the requirements of this section and section 668.41, any incident meeting this definition is considered a crime for the purposes of Clery Act reporting.

## **Hate Crime Definitions for Reportable Crimes**

**Hate Crime**: A criminal offense committed against a person, property, or society, which is motivated, in whole or part, by the offender's bias against a race, religion, disability, sexual orientation, or ethnicity/national origin: also known as a bias crime.

**Larceny-Theft**: The unlawful taking, carrying, leading, or riding away of property from the possession or constructive possession of another. (Note: Constructive possession is defined by Black's Law Dictionary, 6<sup>th</sup> ed. As "where one does not have physical custody or possession, but is in a position to exercise dominion or control over a thing.")

- a. **Pocket-picking**: The theft of articles from another person's physical possession by stealth where the victim usually does not become immediately aware of the theft.
- b. **Purse-Snatching**: The grabbing or snatching of a purse, handbag, etc., from the physical possession of another person.
- c. **Shoplifting**: The theft, by someone other than an employee of the victim, of goods or merchandise exposed for sale.
- d. **Theft From Building**: A theft from within a building which is either open to the general public or where the offender has legal access.
- e. **Theft From Coin Operated Machine or Device**: A theft from a machine or device which is operated or activated by the use of coins.
- f. **Theft From Motor Vehicle**: (Except "Theft of Motor Vehicle Parts or Accessories"); the theft of articles from a motor vehicle, whether locked or unlocked.



- g. **Theft of Motor Vehicle Parts or Accessories:** The theft of any part or accessory affixed to the interior or exterior of a motor vehicle in a manner which would make the item an attachment of the vehicle, or necessary for its operation.
- h. **All Other Larceny:** All thefts which do not fit any of the definitions of the specific subcategories of larceny/Theft listed above.

**Source:** Uniform Crime Reporting Handbook, 2004; U.S. Department of Justice

**Simple Assault:** An unlawful physical attack by one person upon another where neither the offender displays a weapon, nor the victim suffers obvious severe or aggravated bodily injury involving apparent broken bones, loss of teeth, possible internal injury, severe laceration, or loss of consciousness.

**Intimidation:** To unlawfully place another person in reasonable fear of bodily harm through the use of threatening words and/or other conduct, but without displaying a weapon or subjecting the victim to actual physical attack.

**Destruction/Damage/Vandalism of Property (Except “Arson”):** To willfully or maliciously destroy, damage, deface, or otherwise injure real or personal property without the consent of the owner or the person having custody or control of it.

**Source:** Hate Crime Data Collection Guidelines, October 1999; U.S. Department of Justice

## **Fire Safety Definitions**

**Cause of Fire:** The factor or factors that give rise to a fire. The casual factor may be, but not limited to, the result of an intentional or unintentional action, mechanical failure, or act of nature.

**Fire:** Any instance of open flame or other burning in a place not intended to contain the burning or in an uncontrolled manner.

**Fire Drill:** A supervised practice of a mandatory evacuation of a building for a fire.

**Fire-related Injury:** Any instance in which a person is injured as a result of a fire, including an injury sustained from natural or accidental cause while involved in fire control, attempting rescue, or escaping from the dangers of a fire. The term person may include students, faculty, staff, visitors, firefighters or other individuals.

**Fire-related Death:** Any instance in which a person:

- (1) is killed as a result of a fire, including death resulting from a natural or accidental cause while involved in fire control, attempting rescue, or escaping from the dangers of a fire; or
- (2) dies within one year of injuries sustained as a result of the fire

**Fire Safety System:** Any mechanism or system related to the detection of a fire, the warning resulting from a fire, or the control of a fire. This system includes sprinkler systems or other fire extinguishing systems, fire detection devices, stand-alone smoke alarms, devices that alert one to the presence of a fire, such as horns, bells, or strobe lights; smoke-control and reduction mechanisms; and fire doors and walls that reduce the spread of fire.

**Value of Property Damage:** The estimated value of the loss of the structure and contents, in terms of the cost of replacement in like kind and quantity. This estimate should include contents damaged by fire, and related damages caused by smoke, water, and overhaul; however, it does not include indirect loss, such as business interruption.

**Moreno Valley College**  
 Riverside Community College District  
 16130 Lasselie Street  
 Moreno Valley, CA 92551-2045

- Emergency Telephones
- Restrooms
- Free Speech Area
- Accessible Parking
- Patient Parking
- Parking Pay Station

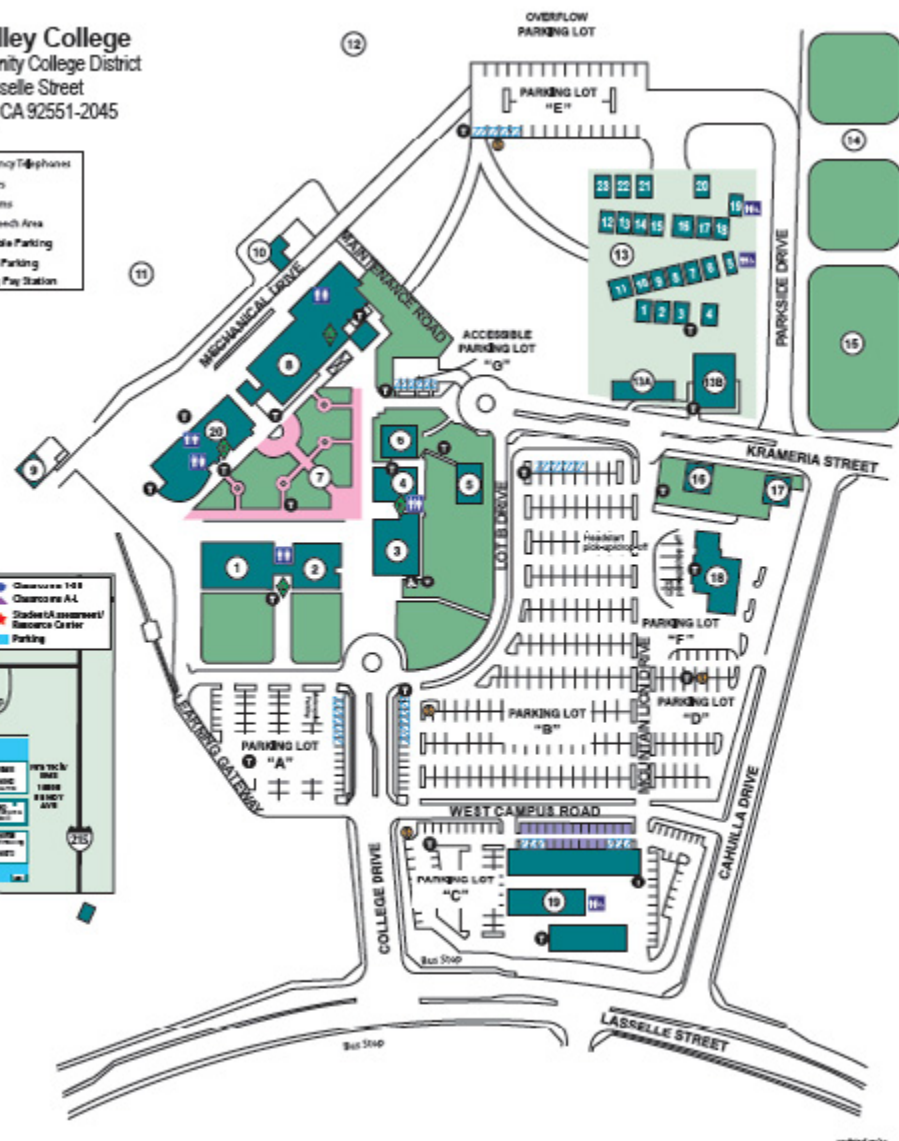

1. **LIBRARY & ID**  
 Disabled Student Services  
 Middle College High School Office  
 Wellness Services
2. **STUDENT SERVICES (SU)**  
 Admissions  
 Assessment Center  
 Career and Transfer Center  
 Counseling Services  
 Dean of Student Services  
 E.O.P.S./CARE  
 Puerto  
 Renaissance Scholars Program  
 Student Financial Services  
 URMU (Student Board)  
 Vice President, Student Services
3. **SCIENCE AND TECHNOLOGY (SC)**  
 Computer Lab/STEM Center  
 Grants and College Support  
 Science Labs  
 Science Labs  
 IT/ITC
4. **LOBBY SEN CAFE**
5. **STUDENT ACTIVITIES CENTER**  
 ASMC Student Government
6. **BOOKSTORE**
7. **JOHN M. COUDRETS, JR. PLAZA**
8. **HUMANITIES (HU)**  
 Academic Departments:
  - Business and Information Technology Systems
  - Communications
  - Humanities, Arts and Social Sciences
  - Mathematics
  - Science and Knowledge
 Dean of Student Services (Coaching)  
 Evaluations  
 Math Lab  
 Meeting Room (HUM 134)  
 Open Computer Lab  
 Workforce Prep/Collaborative  
 Writing and Reading Lab
9. **PHASE I MECHANICAL BUILDING**
10. **PHASE II MECHANICAL BUILDING**
11. **EDMUND C. JAMESON GILBERT INSTITUTE**
12. **CROSS COUNTRY TRACK**
13. **PARKSIDE COMPLEX (PKC)**
  - 1 College Police/Parking Services
  - 2 Music Practice Rooms
  - 3-4 Classroom
  - 5 Restrooms
  - 6 Health Services
  - 7-10 Classroom
  - 11 Mail
  - 12 Classroom
  - 14A Meeting Room
  - 14B Human Services Lab
  - 15 Health Science Programs
  - 16-18 Classroom
  - 19 Restrooms
  - 20 Classroom
  - 21 Physician Assistant Program
  - 22-23 Classroom
- 13A. **PEC BARRACKHOUSE**  
 Facilities Office  
 Mailroom
- 13B. **PEC MULTIPURPOSE BUILDING**
14. **SPORTS FIELDS**
15. **COLLEGE PARK**
16. **ADMINISTRATION ANNEX**  
 President  
 Vice President, Business Services  
 HEADQUARTERS  
 16. **EARLY CHILDHOOD EDUCATION CENTER (ECEC)**
16. **DENTAL EDUCATION CENTER (DEC)**
20. **STUDENT ACADEMIC SERVICES (SAS)**  
 Center for Professional Development  
 Dean, Individual Effectiveness  
 Dean of Instruction  
 Faculty Offices  
 Faculty Work Rooms  
 Meeting Rooms  
 Technology Support Services  
 Tutorial Services  
 Vice President, Academic Affairs

**Appendix A**

*An institutional report in compliance with the  
Jeanne Clery Disclosure of Campus Security Policy  
and campus Statistics and the 2008 Higher Education Opportunity Act.*



(951) 571-6100 • FAX (951) 571-6176  
16130 Lasselle Street • Moreno Valley, CA 92551  
[www.mvc.edu](http://www.mvc.edu)